



Factory 13/5 Speedwell St

Somerville VIC 3912

☎ 03 5978 8755

☎ 1800 001 018

[www.RoofExtenda.com.au](http://www.RoofExtenda.com.au)

## SHADE SAIL ANCHOR INSTALLATION GUIDE FOR TIN ROOF

### General Installation

- 1 Lift roof sheet to achieve an opening to fit the Roof Extenda Shade Sail Anchor.
- 2 Bolt the section with the steel rod & the backing plate to the selected rafter using 4x M12 hex bolts. Secure both brackets to the top plate with 2x M10 coach screws through to each bracket.
- 3 Replace the roof sheet or roof sheet, cutting a hole to allow the loop to penetrate the roof.



### Care Instructions

Roof Extenda recommends painting or powder coating the Shade Sail Anchor before installation for additional corrosive protection. Shade Sail Anchors to be cleaned and inspected yearly and re-coated if required.

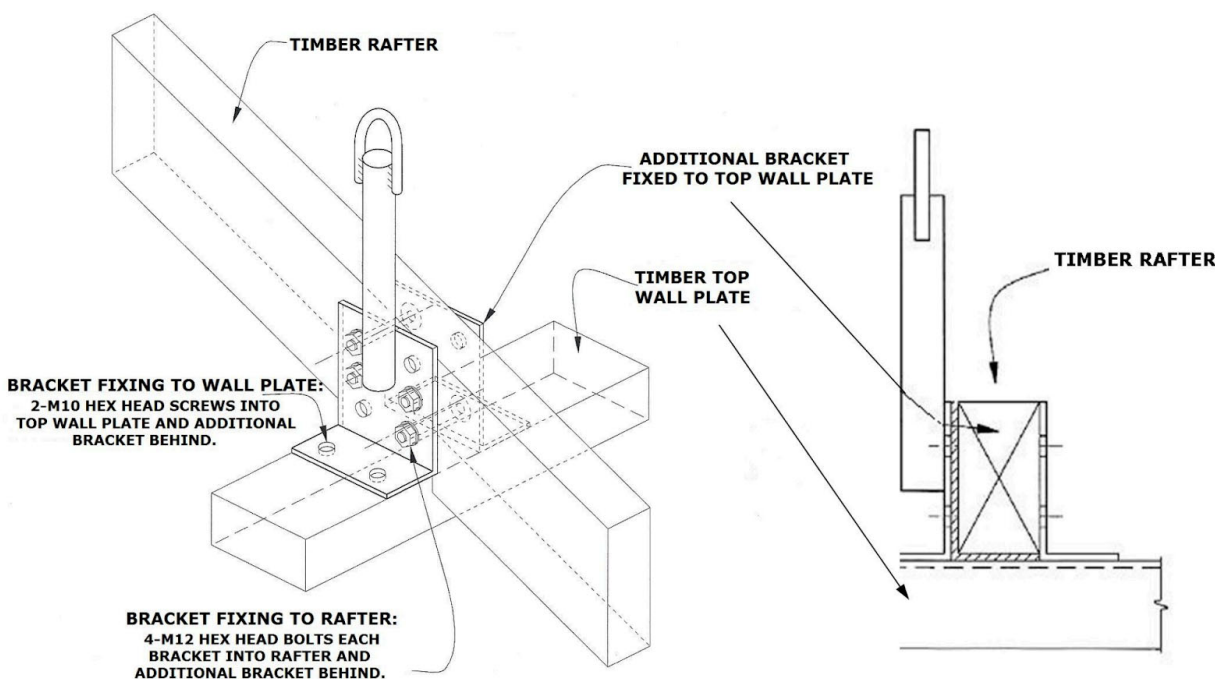

### Note

Local Council or Shire approval may be required prior to construction. Roof Extenda accepts no responsibility for the type of construction undertaken. The Shade Sail Anchor has been strength tested. When bolted in the top holes, the Anchor can withstand up to 2.3kN of force. When bolted in the middle holes, the Anchor can withstand up to 1.3kN of force. We advise you carefully evaluate the shade sail size, location, wind category & installation design before purchasing.

## FlashRite Weather Seal

- 1 Lift roof sheet to achieve an opening to fit the Shade Sail Anchor.
- 2 Bolt the section with the steel rod and the backing plate to the rafter using 4x M12 hex bolts. Secure both brackets to the top plate with 2x M10 coach screws to each bracket
- 3 Replace the roof sheet, cutting a hole to allow the loop to penetrate the roof.
- 4 Cut cone to the exact corresponding anchor outside diameter. We recommend a sharp pair of scissors to cut our anchor flashing for the correct anchor size. Ensure there are no accidental nicks in the polymer, as this will continue to split/tear over time.

**Tip: Ensure the blades are sharp with no contamination e.g. glue or any accumulated dirt.**

- 5 Lubricate the anchor with water prior to attaching the weather seal.
- 6 Form the weather seal to the profile of the roof and mark out the position of the weather seal.
- 7 Slide the weather seal up the bracket to apply neutral cure sealant inside the area marked, press the weather seal into position and finish with a bead of sealant to the edges of the weather seal to complete the fitting.
- 8 Realign weather seal onto roof and fix with Class 3 or Class 4 hex head self-drilling screws minimum of 16mm long with a rubber washer.

CUT CONE TO EXACT  
CORRESPONDING BRACKET  
PIPE DIAMETER

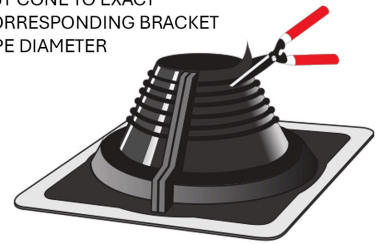

WHEN SLIDING FLASHING  
DOWN TOP BRACKET PIPE  
WITH WATER

FORM TO  
ROOF PROFILE

MARK OUT  
SEALANT PATHS

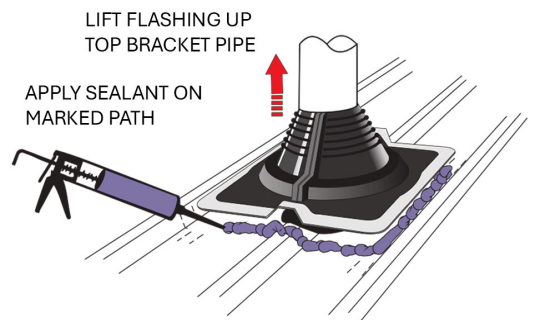

LIFT FLASHING UP  
TOP BRACKET PIPE

APPLY SEALANT ON  
MARKED PATH

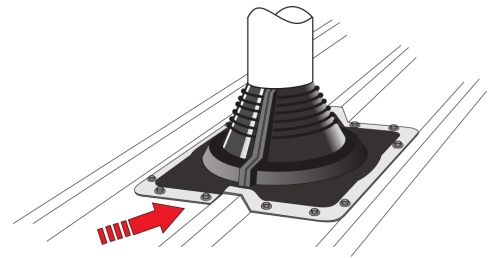

REALIGN FLASHING ONTO ROOF AND FIX  
WITH APPROPRIATE FASTENERS. START HERE.

## If Retro-Fitting a Weather Seal:



SPLIT SHOULDERS  
WITH SCISSORS

CRIMP FLASHING  
SHOULDERS WITH  
RETROFIT CLIPS.  
FACE JOINT DOWNSTREAM.

