



Factory 13/5 Speedwell St

Somerville VIC 3912

☎ 03 5978 8755

☎ 1800 001 018

[www.RoofExtenda.com.au](http://www.RoofExtenda.com.au)

## SHADE SAIL ANCHOR INSTALLATION GUIDE FOR TILE ROOF

### General Installation

- 1 Remove roofing tiles to achieve an opening to fit the Roof Extenda Shade Sail Anchor.
- 2 Bolt the section with the steel rod and the backing plate to the selected rafter using 4x M12 hex bolts. Secure both brackets to the top plate with 2x M10 coach screws through to each bracket.
- 3 Replace the roof tiles, cutting a hole to allow the loop to penetrate the roof.



### Care Instructions

Roof Extenda recommends painting or powder coating the Shade Sail Anchor before installation for additional corrosive protection. Shade Sail Anchors to be cleaned and inspected yearly and re-coated if required.

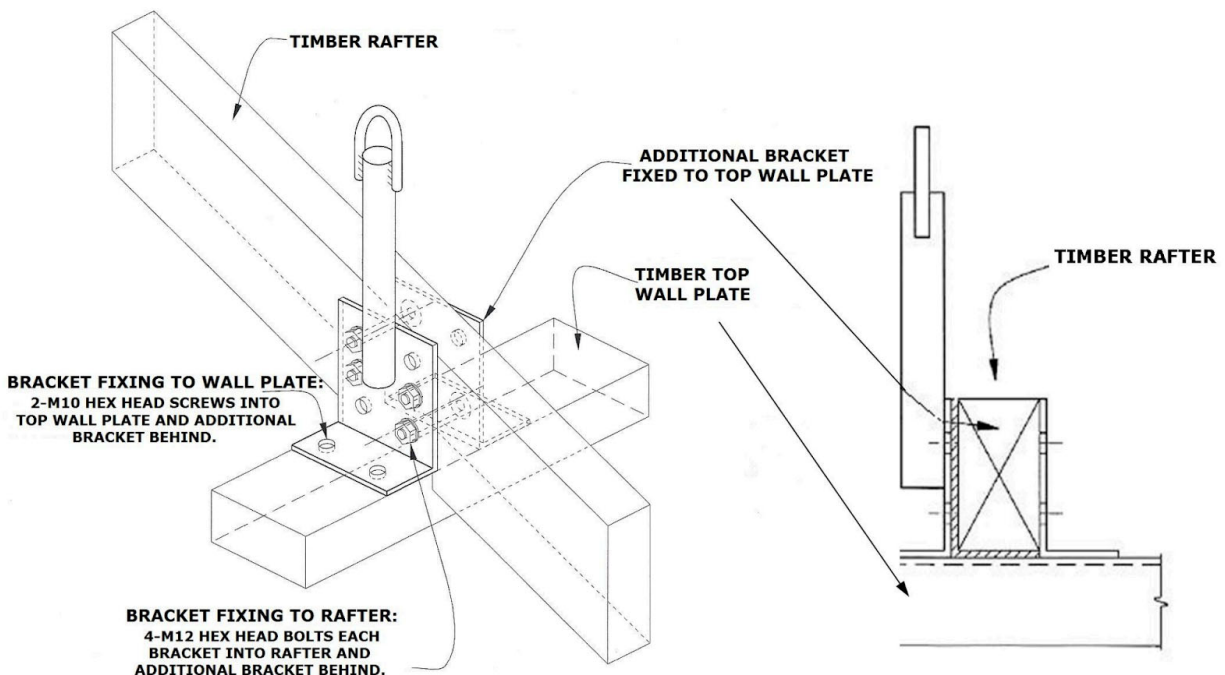

### Note

Local Council or Shire approval may be required prior to construction. Roof Extenda accepts no responsibility for the type of construction undertaken. The Shade Sail Anchor has been strength tested. When bolted in the top holes, the Anchor can withstand up to 2.3kN of force. When bolted in the middle holes, the Anchor can withstand up to 1.3kN of force. We advise you carefully evaluate the shade sail size, location, wind category & installation design before purchasing.

## Flexatile

- 1** Remove roofing tiles to achieve an opening to fit the Shade Sail Anchor.
- 2** Bolt the section with the steel rod and the backing plate to the rafter using 4x M12 hex bolts. Secure both brackets to the top plate with 2x M10 coach screws to each bracket.
- 3** Replace the roof tiles, cutting a hole to allow the loop to penetrate the roof.
- 4** Ensure tiles are cleaned before installing the Flexatile flashing to ensure the butyl adhesive strips can have maximum effect when bonded to the tiles.
- 5** Cut the rubber cone at least 15mm smaller than the anchor's outside diameter with a sharp pair of scissors. Ensure there are no accidental nicks in the polymer, as this will continue to split/tear over time.  
  
**Tip: Ensure the blades are sharp with no contamination e.g. glue or any accumulated dirt.**
- 6** Remove the middle lining from the underside of the flexatile, so the anchor is given access to the rubber boot.
- 7** Lubricate the anchor with water and slide the Flexatile down.
- 8** Form an anti-capillary fold at the top of the base sheet.
- 9** Remove the protective backing from the underside of the flashing, that is covering the butyl adhesive strips.
- 10** Hand form the base all around the tile and apply pressure to the butyl adhesive side strip.

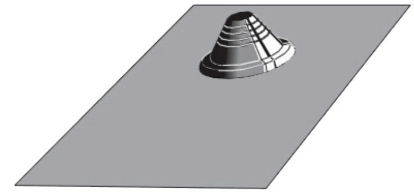

BASE SHEET CHOICE  
a) ACRYFLASH  
b) ALUMINIUM  
c) RE-INFORCED POLYMER

