



Bracket Computation Request

Instructions

Before returning this form to Roof Extenda, please ensure you've met each and EVERY requirement as listed just below.

- Filled out **EVERY** section in available spaces on both forms below.
- Attach a copy of your building plans
(This will help us assist you, but is no substitute for filling out the form).
- Ensured that your contact information is correct.
- Read and understood the section in Green.
- Ensure **BOTH** pages are completed before returning

There is no cost to you for this service*. Please allow 24 hours for a reply

(*Fees may apply if independent certification is required)

You can send these forms in via E-MAIL to info@roofextenda.com.au

Or via FAX on 03 5978 8016

If you have any further questions, please CALL us on (03) 5978 8755

NOTE:

IF ALL THE SECTIONS OF THE FORMS ARE NOT FILLED OUT, WE WILL BE UNABLE TO ASSIST YOU WITH YOUR REQUEST.

Date: _____

Bracket Computation Request

- This request form covers pergola or carport flat roofs which are ($\leq 15^\circ$) or pitched roofs ($\leq 30^\circ$) with open gable ends.
- For complex roof shapes or where walls or enclosed gable ends are proposed, please contact us at Roof Extenda.
- Ensure wall top plate is 90mm or greater before proceeding with this form or bracket installation.

CLIENT NAME: _____ FLAT / GABLE ROOF: _____

SITE ADDRESS: _____ STATE: _____

CONTACT DETAILS: Name: _____ Tel: _____

Email: _____

Office use only
 Ref: _____
 Date: _____
 Page No: _____

Return completed form to:
 Email: info@roofextenda.com.au
 Phone: 03 5978 8755
 Fax: 03 5978 8016

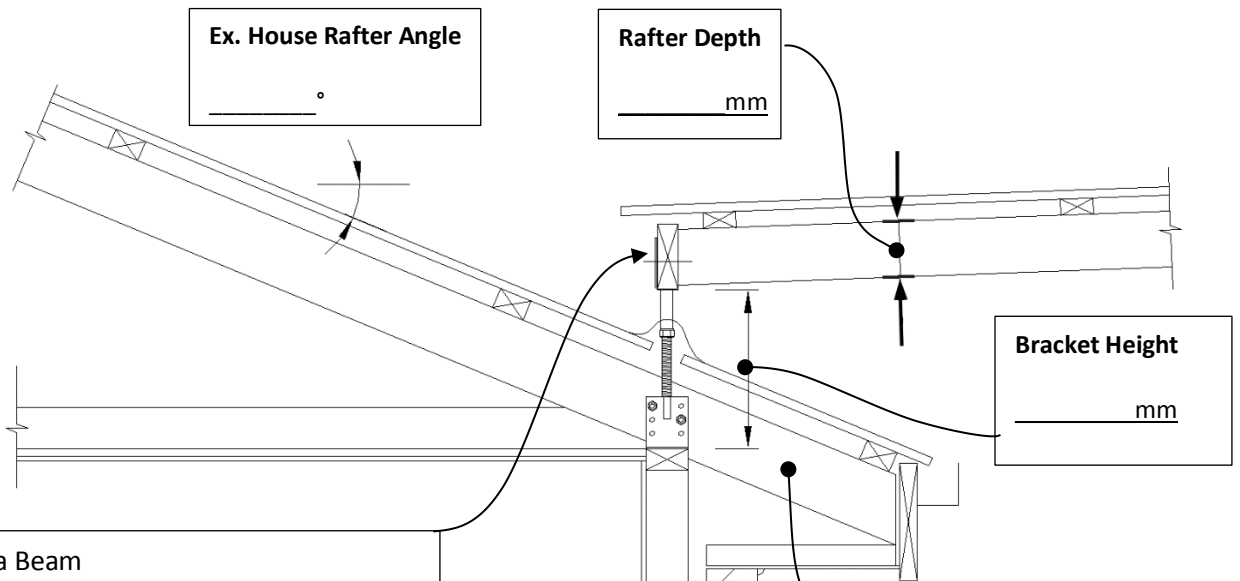

Pergola Beam
 Size: _____ Thickness: _____ mm
Timber type:

F8 OB Hardwood	<input type="checkbox"/>
F17 Kiln Dried Hardwood	<input type="checkbox"/>
Mixed Aus. Hardwood Seasoned	<input type="checkbox"/>
Mixed Aus. Hardwood Unseasoned	<input type="checkbox"/>
LVL	<input type="checkbox"/>
Oregon	<input type="checkbox"/>
Radiata Pine, MGP Grades	<input type="checkbox"/>
Treated Pine Seasoned	<input type="checkbox"/>
Treated Pine Unseasoned	<input type="checkbox"/>

Steel type:

Cee	<input type="checkbox"/>
Zed	<input type="checkbox"/>
Box	<input type="checkbox"/>

Existing House Rafter
 Size: _____
 Type:

F8 OB Hardwood	<input type="checkbox"/>
F17 Kiln Dried Hardwood	<input type="checkbox"/>
Mixed Aus. Hardwood Seasoned	<input type="checkbox"/>
Mixed Aus. Hardwood Unseasoned	<input type="checkbox"/>
Oregon	<input type="checkbox"/>
Radiata Pine, MGP Grades	<input type="checkbox"/>
Treated Pine Seasoned	<input type="checkbox"/>
Treated Pine Unseasoned	<input type="checkbox"/>
Other:	<input type="checkbox"/>

Bracket Computation Request

Date _____

- This request form covers pergola or carport flat roofs which are ($\leq 15^\circ$) or pitched roofs ($\leq 30^\circ$) with open gable ends.
- For complex roof shapes or where walls or enclosed gable ends are proposed, please contact us at Roof Extenda.
- Ensure wall top plate is 90mm or greater before proceeding with this form or bracket installation.

Office use only
 Ref: _____
 Date: _____
 Page No: _____

Return completed form to:
Email: info@roofextenda.com.au
Phone: 03 5978 8755
Fax: 03 5978 8016

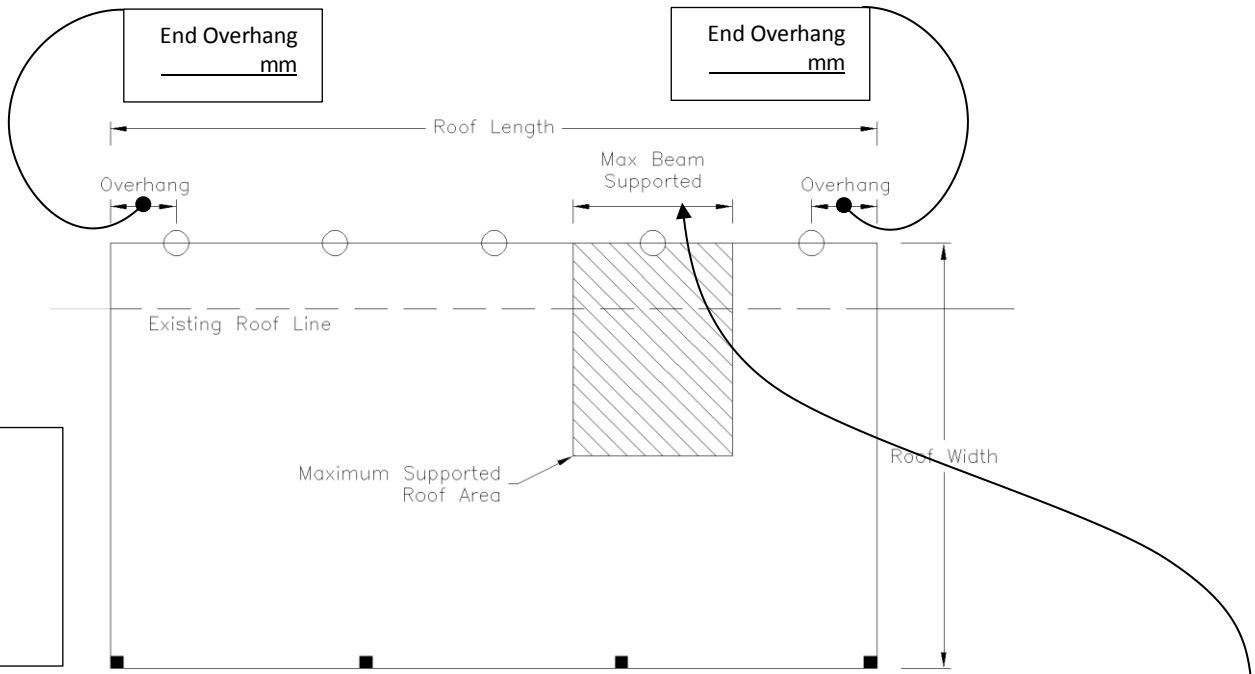

WIND CLASS
 N _____
 Or
 C _____

Pergola Roof Dimensions
 Length: _____ mm
 Width: _____ mm
 Preferred no. brackets / no. of available fixing points: _____

Pergola Roof Construction:

Metal deck, no ceiling	<input type="checkbox"/>
Metal deck, plaster ceiling	<input type="checkbox"/>
Tile, no ceiling	<input type="checkbox"/>
Tile, plaster ceiling	<input type="checkbox"/>

Specific Roof mass: _____ kg/m²

Insulated Panel
 Thickness: _____ mm
 (50/75/100/125/150 mm)

Maximum supported beam length by a single bracket.
 If Brackets **ARE NOT** to be evenly distributed, please supply maximum supported length
 _____ mm

If the Pergola will have an Infill or Fascia please provide the Meters² or Dimensions Below:

